

인터락 시스템 INTER LOCK₂₅

적용 : 외장, 천정

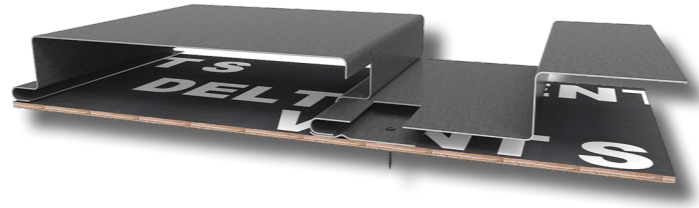

인터락 시스템은 실용신안등록된 제품으로 효율적 시공이 가능한 새로운 타입의 외장패널 공법입니다. 자유로운 노출폭의 조정이 가능하기 때문에 다양한 디자인에 대응할 수 있다는 장점이 있습니다. 간편한 끼워치기 방식의 시공법은 효율적 공사와 공기단축을 가능하게 해줍니다. 소핏락 시스템은 Zinc, Aluminum, Copper, Galva 등 여러 금속 소재에 적용이 가능하며, 기존의 디자인과는 다른 건축물의 입면을 완성하기에 적합합니다.

인터락 시스템 노출폭 (원자재 /가공 후 폭)

인터락 420폭_최소폭 (WIDTH: 420mm / 320mm)

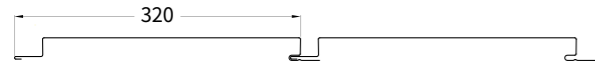

인터락 500폭 (WIDTH: 500mm / 400mm)

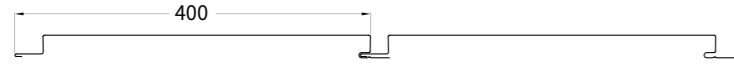

인터락 600폭 (WIDTH: 600mm / 500mm)

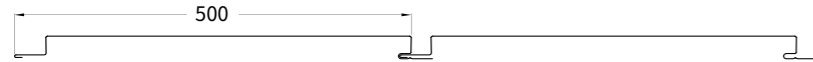

인터락 시스템 3D 전개도

- ① 금속마감재
- ② 투습방수지 (DELTA VENT N)
- ③ 내수합판
- ④ EPS 단열재
- ⑤ 각파이프
- ⑥ 콘크리트

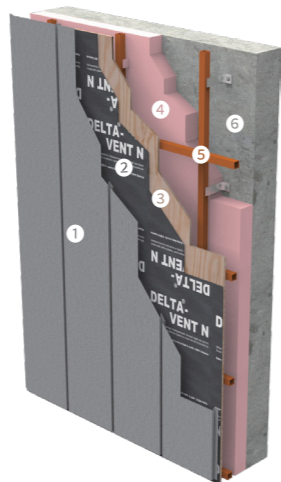

인터락 시스템 주름 옵션

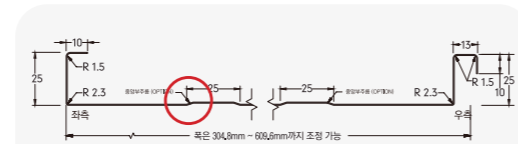

BEAD RIBS

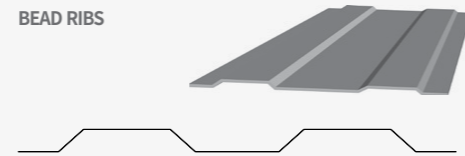

PENCIL RIBS (Small, Large 2종)

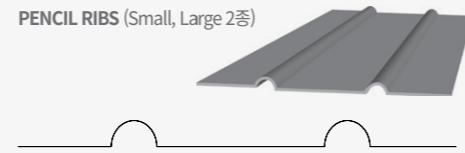

V-RIBS (Small, Large 2종)

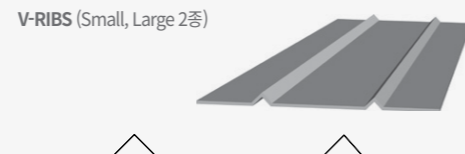

인터락 시스템 비드 상세도 (양쪽주름형)

BEAD 없음

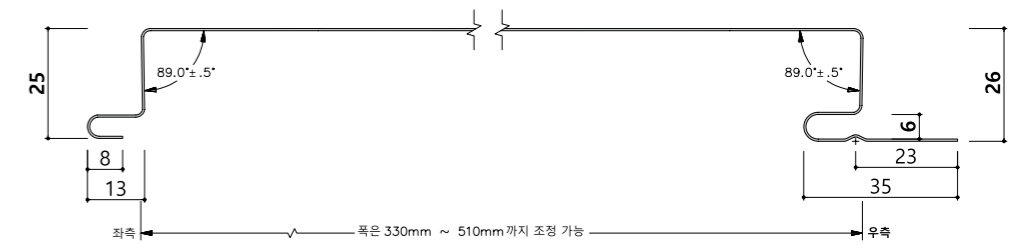

BEAD RIBS

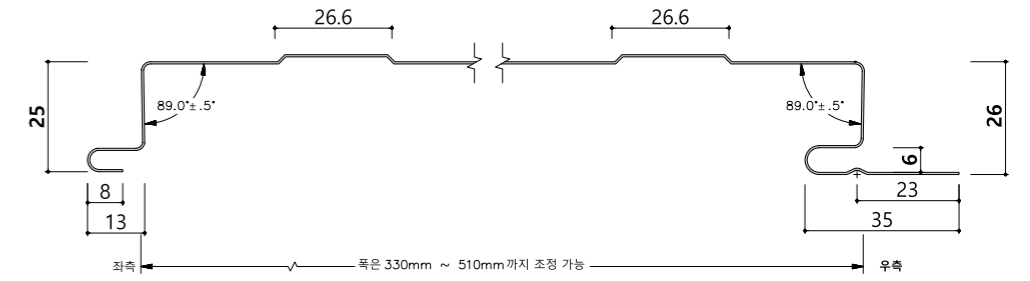

PENCIL RIBS
- Large

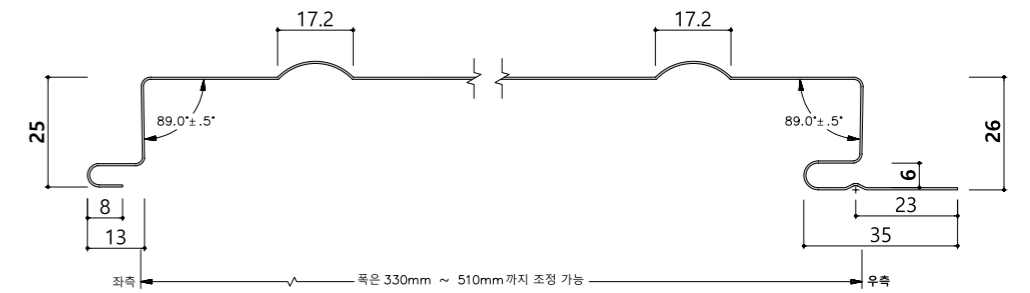

V-RIBS
- Large

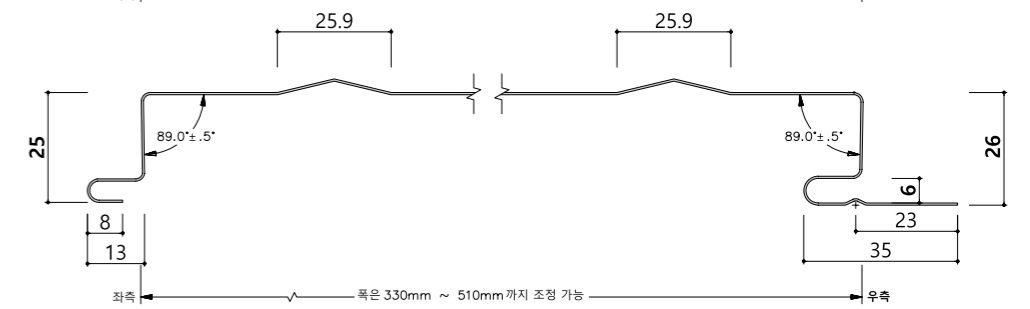

PENCIL RIBS
- Small

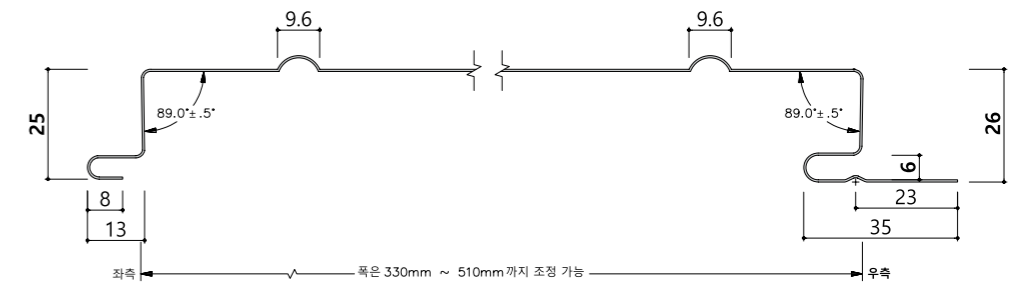

V-RIBS
- Small

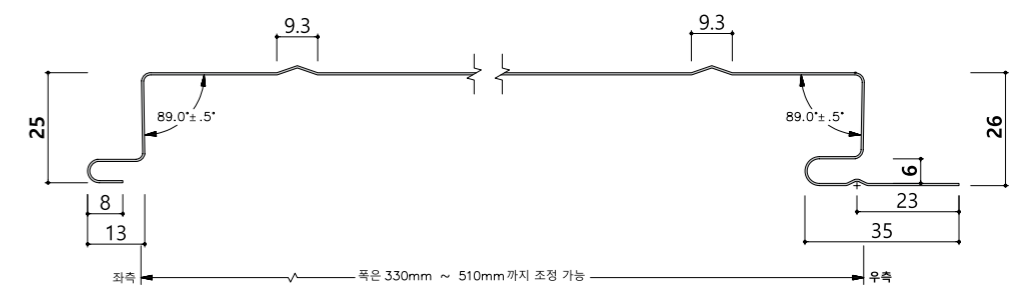

인테리어 시스템 비드 상세도 (한쪽주름형)

BEAD 없음

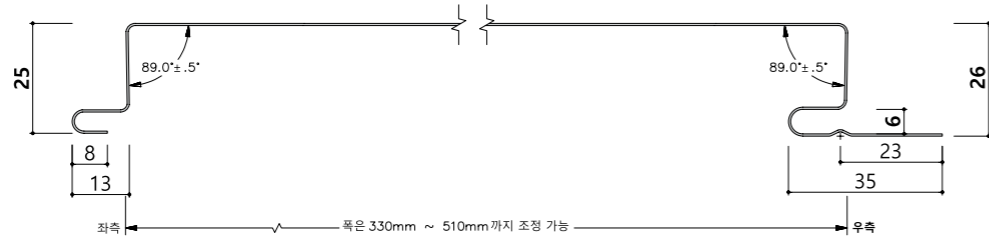

BEAD RIBS

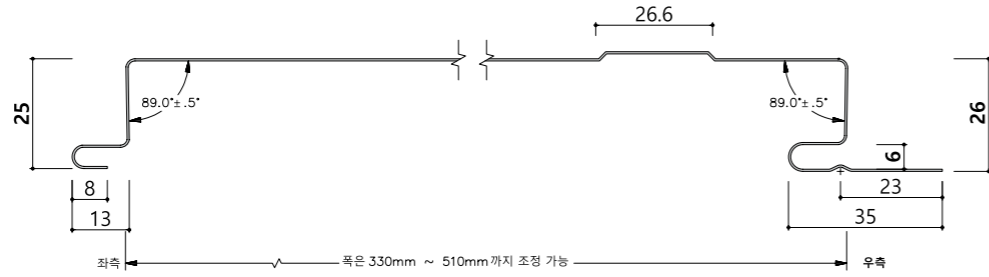

PENCIL RIBS
- Large

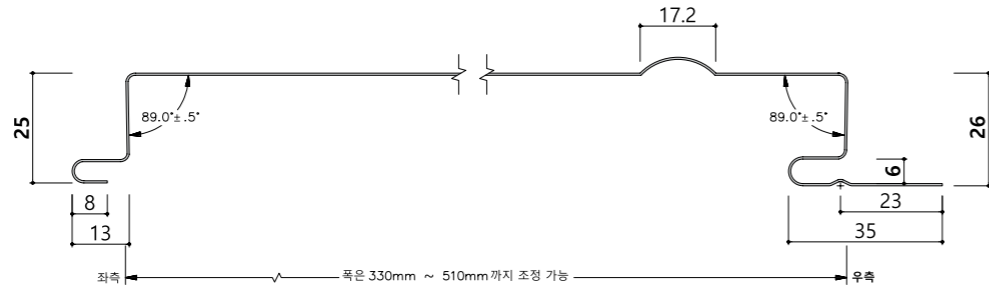

V-RIBS
- Large

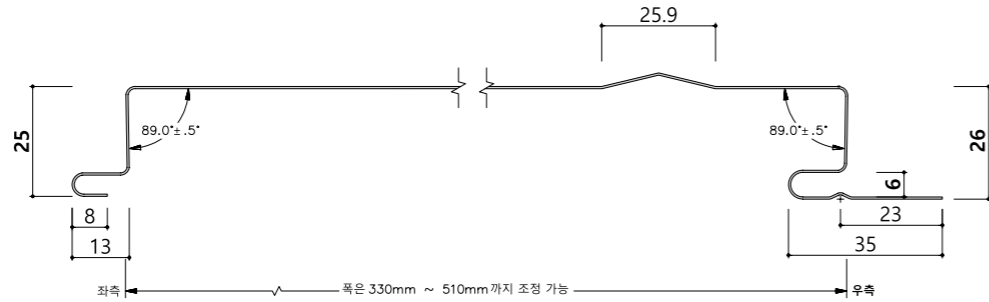

PENCIL RIBS
- Small

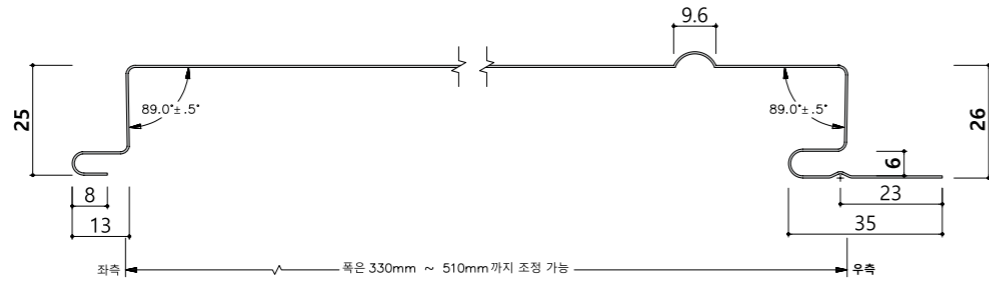

V-RIBS
- Small

